

Architectural Designs ...selling quality house plans for over 30 years.

Plan W55061BR: Southern Splendor



House plans are Copyright © 2009 by our architects and designers.

- Arches, columns, three sets of French doors and a columned porch dress up the front elevation of this split-bedroom design. In back, another covered porch extends to a deck, which in turn steps down to a patio.
- Sloped ceilings top both the dining room and the master bedroom.
- The open living area comprises the kitchen with its angled eating bar, the living room with its corner fireplace, and both formal and informal dining areas.
- The isolated master suite includes a walk-in closet and a bath with both a tub and separate shower. On the other side of the living area, the second bath serves the secondary bedrooms.
- With thick exterior walls, the home is designed for energy efficiency.
- Ceilings: 8' standard; 12' living room, dining room, kitchen.
- Foundation options: basement, slab or crawl space. Please specify when ordering.
- Related Plan: For a 2x6 framed version of this house plan, see 5527BR.

Style: Southern, Traditional

Total Living Area: 1672

Main Flr.: 1672

Front Porch: 252 sq. ft.

Rear Porch: 125 sq. ft.

Storage: 96 sq. ft.

Total Square Feet: 2,665 sq. ft.

Attached Garage: 2 Car, 520 sq. ft.

Bedrooms: 3

Full Bathrooms: 2

Width: 68'

Depth: 60'

Maximum Ridge Height: 24'

Exterior Walls: ICF

Ceiling Height:

Main Floor: 8'

Other: 12' Living Room, Dining Room, Kitchen & MBR

Standard Foundations: Crawl

Alternate Foundations: Slab (no charge), Basement (\$50)

Special Features: 1st Floor Master Suite, PDF

One Set	Five Sets	Eight Sets	Reproducible	PDF File	CAD
\$529	\$594	\$634	\$734	\$734	\$1,468

Main Level

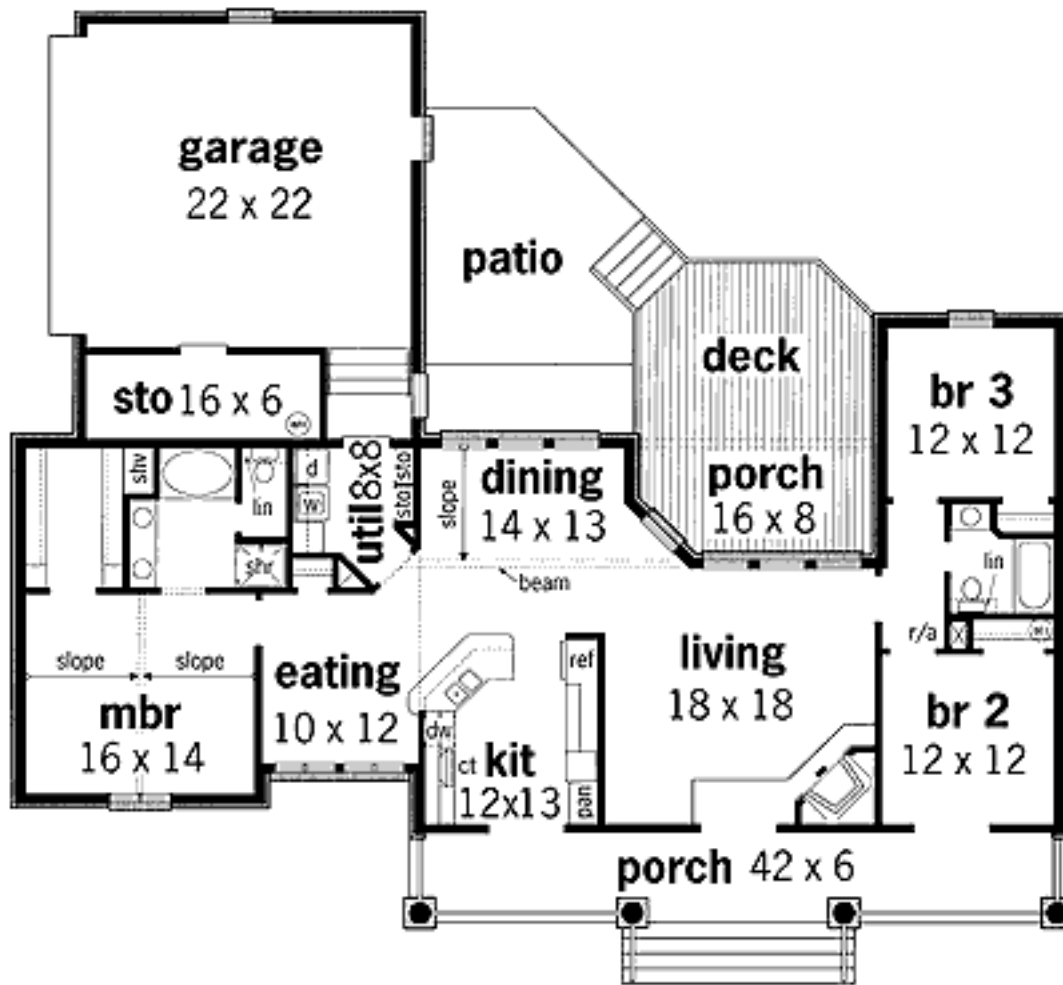

Rear View

