

Architectural Designs ...selling quality house plans for over 30 years.

Plan W90082PD



House plans are Copyright © 2009 by our architects and designers.

Style: Canadian, Metric, Multi-Family

Total Living Area: 2428

Main Flr.: 607

2nd Flr.: 607

Basement Unfinished: 607 sq. ft.

Total Square Feet: 3,882 sq. ft.

Attached Garage: 1 Car, 240 sq. ft.

Bedrooms: 3

Full Bathrooms: 1

Half Bathrooms: 1

Width: 40'

Depth: 32'

Maximum Ridge Height: 28'5"

Exterior Walls: 2x6

Ceiling Height:

Main Floor: 8'

2nd Floor: 8'

Standard Foundations: Basement

Special Features: PDF, Narrow Lot, CAD Available

One Set	Five Sets	Eight Sets	Reproducible	PDF File	CAD
\$660	\$735	\$760	\$955	\$955	\$1,495

Main Level

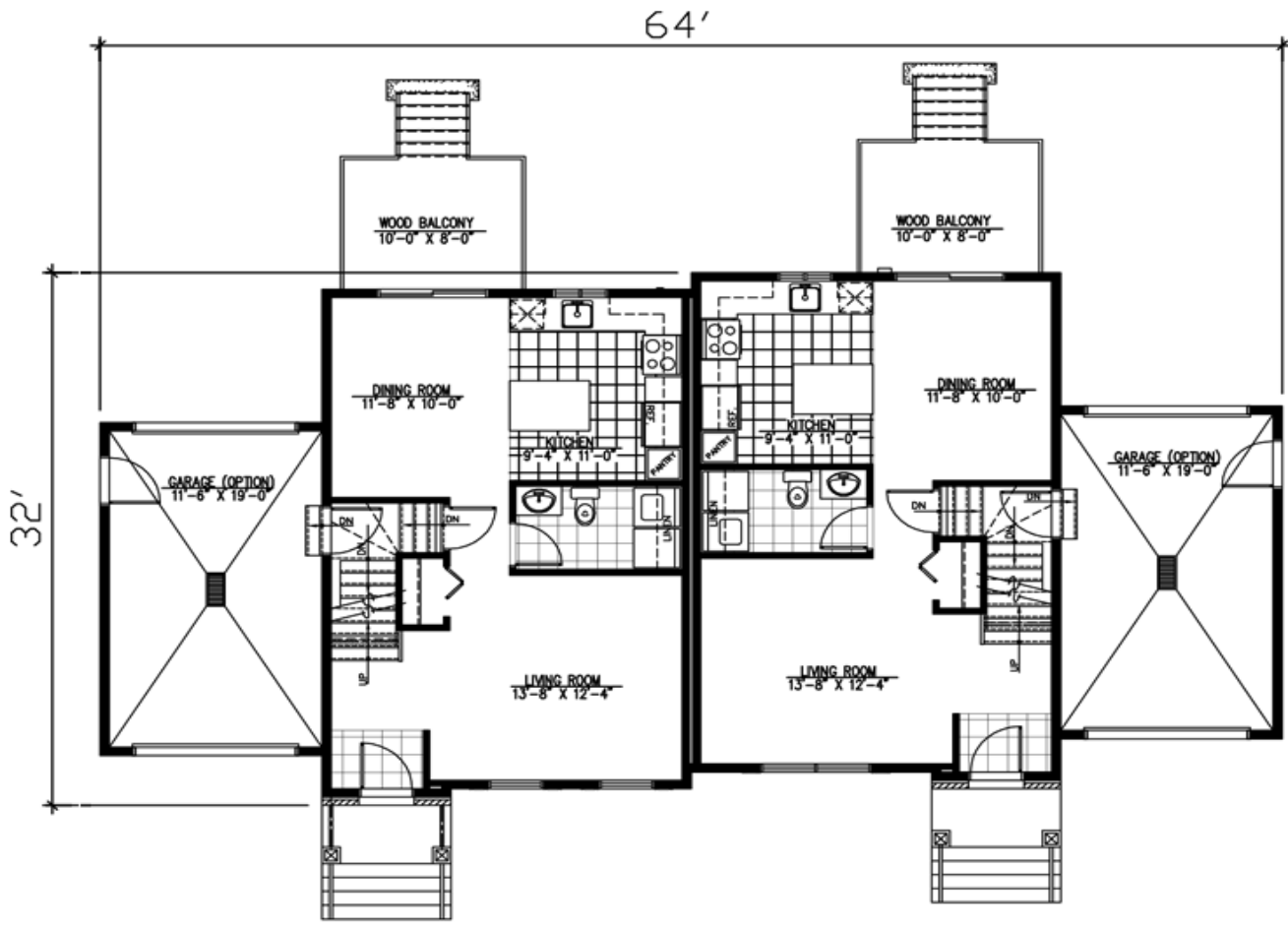

OPTIONAL GARAGE: 240 SQ.FT/UNIT

2nd Level

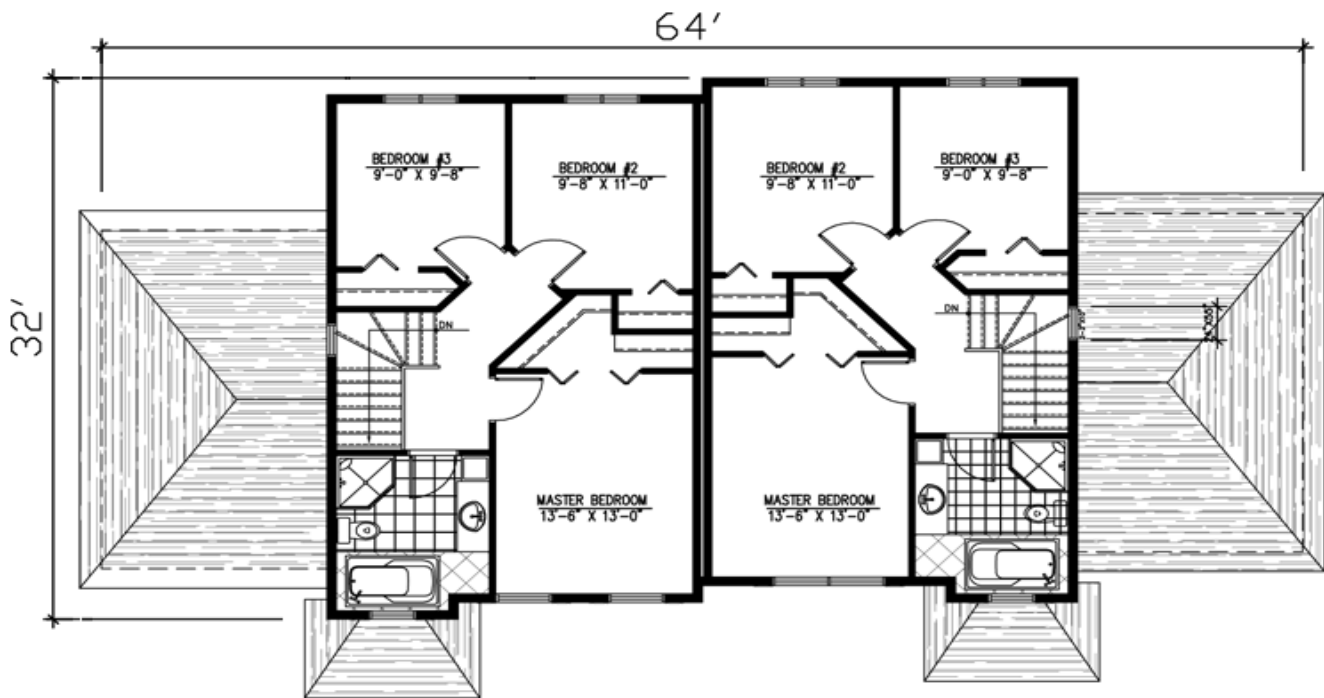

Sides/Rear



Rear elevation



Left elevation



Right elevation