

Architectural Designs ...selling quality house plans for over 30 years.

Plan W57093HA: Affordable Two-Story Has It All



House plans are Copyright © 2009 by our architects and designers.

- Multi-gabled facade and elongated porch create a pleasing country appeal.
- Large dining room with bay window and view to rear patio opens to a full-functional kitchen with snack bar.
- An attractive U-shaped stair with hall overlook leads to the second floor.

Style: Country, Traditional

Total Living Area: 1308

Main Flr.: 670

2nd Flr.: 638

Basement Unfinished: 652 sq. ft.

Total Square Feet: 2,372 sq. ft.

Attached Garage: 2 Car, 412 sq. ft.

Bedrooms: 3

Full Bathrooms: 1

Half Bathrooms: 2

Width: 54'

Depth: 29'

Maximum Ridge Height: 24'

Exterior Walls: 2x4

Ceiling Height:

Main Floor: 8'

2nd Floor: 8'

Standard Foundations: Basement

Special Features: CAD Available, PDF

One Set
\$470

Five Sets
\$570

Eight Sets
\$670

Reproducible
\$770

PDF File
\$770

CAD
\$1,370

Main Level

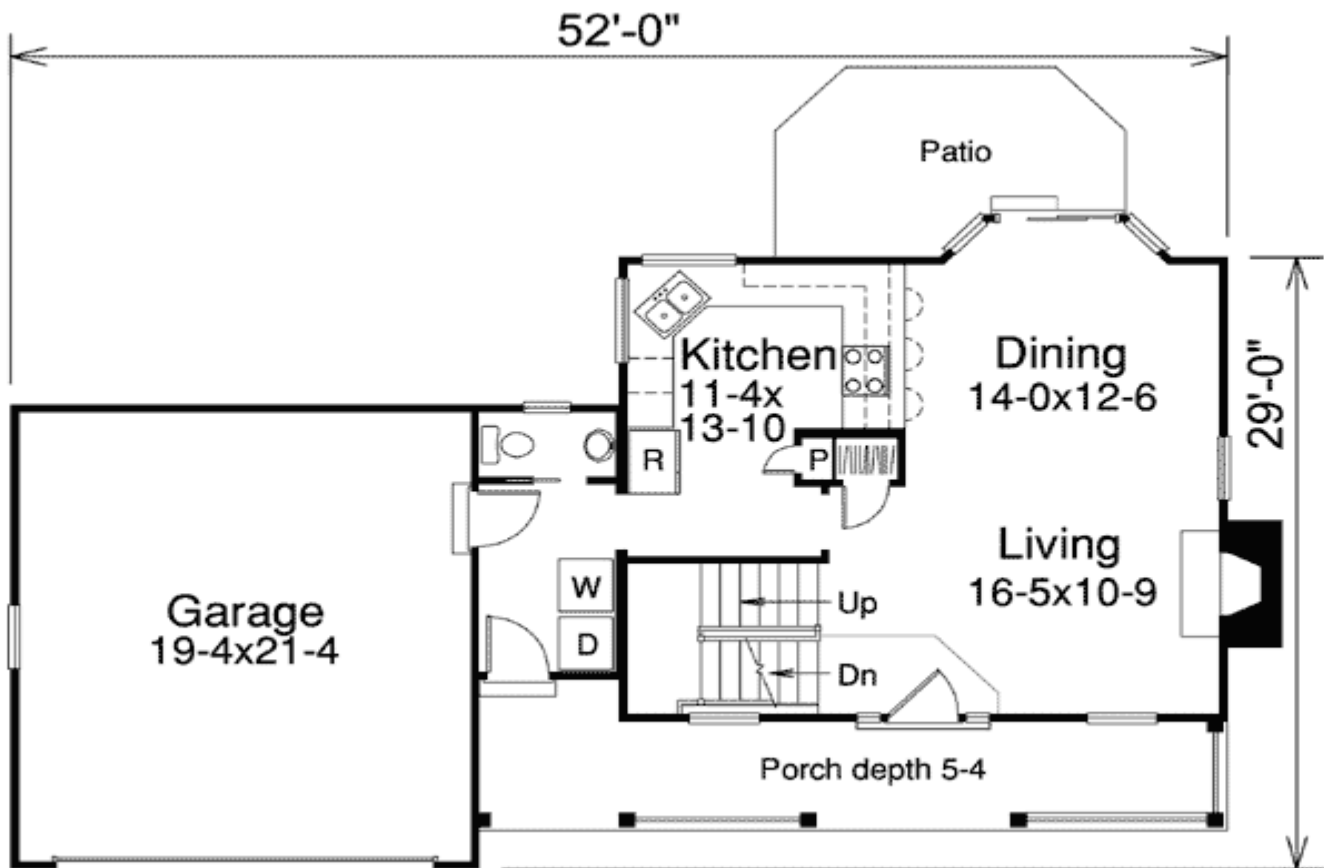

2nd Level

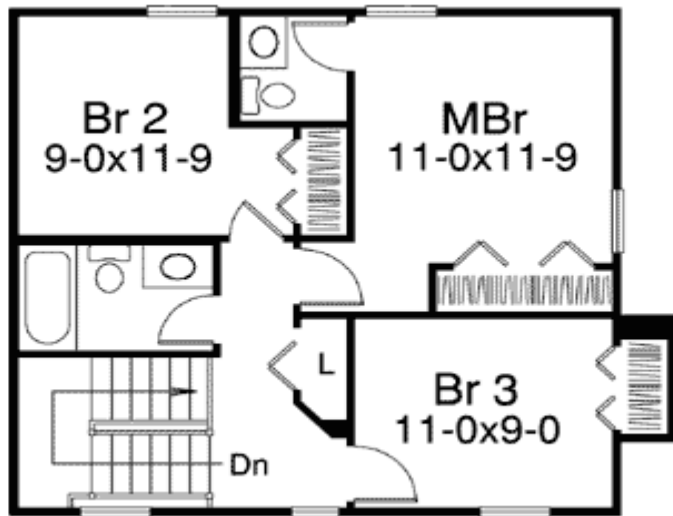

Sides/Rear

