

Plan W69022AM: Single Story Home Plan



House plans are Copyright © 2009 by our architects and designers.

- This one-story house plan makes efficient use of a moderate footprint and is adorned with special details such as a covered porch, shuttered windows and a sidelighted entry. The interior also contains a wealth of amenities that make this home a standout.
- Both the great room and the master salon are vaulted. The great room has a beamed ceiling and a fireplace flanked by windows overlooking a vaulted porch.
- Look for a built-in desk in the kitchen and built-ins or a hutch recess in the dining area. The den opens through double doors and has an optional built-in desk or closet.
- Two full baths in the house plan include a compartmented master bath with spa tub, and a bath shared by Bedrooms 2 and 3. Bedroom 3 features built-in shelves; Bedroom 2 has an arched window.
- A large shop area adds to the convenience of the two-car garage. Reach the garage via an entrance in the laundry room.
- Related Plans: For alternate versions, see these related house plans - 6930AM, 6965AM and 69023AM.

Style: Cottage, Northwest

Total Living Area: 2013

Main Flr.: 2013

Workshop: 178 sq. ft.

Total Square Feet: 2,628 sq. ft.

Attached Garage: 3 Car, 437 sq. ft.

Bedrooms: 3

Full Bathrooms: 2

Width: 60'

Depth: 52'

Maximum Ridge Height: 27'

Exterior Walls: 2x6

Ceiling Height:

Main Floor: 9'

Other: Vaulted Great Room & MBR

Standard Foundations: Crawl

Alternate Foundations: Slab (\$105), Basement (\$250)

Special Features: PDF, 1st Floor Master Suite, Photo Gallery, CAD Available, Den-Office-Library-Study, Split Bedrooms

One Set	Five Sets	Eight Sets	Reproducible	PDF File	CAD
\$575	\$625	\$700	\$925	\$925	\$1,575

Main Level

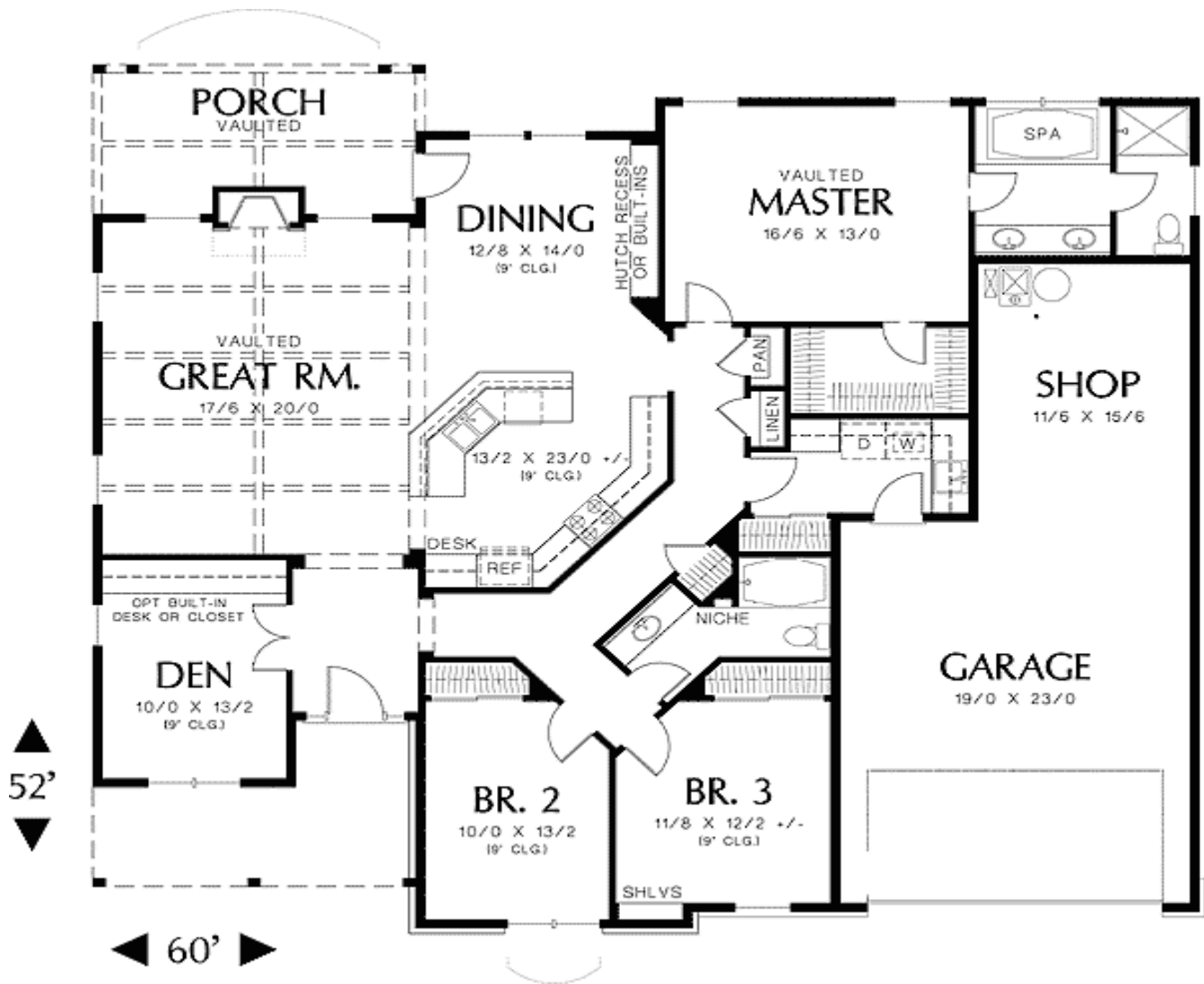

Architectural Designs ...selling quality house plans for over 30 years.

Photo



Architectural Designs ...selling quality house plans for over 30 years.

Elevation #2



Rear View



Great Room



Dining Room

