

Architectural Designs ...selling quality house plans for over 30 years.

Plan W40829DB: Structural Insulated Panel House Plan

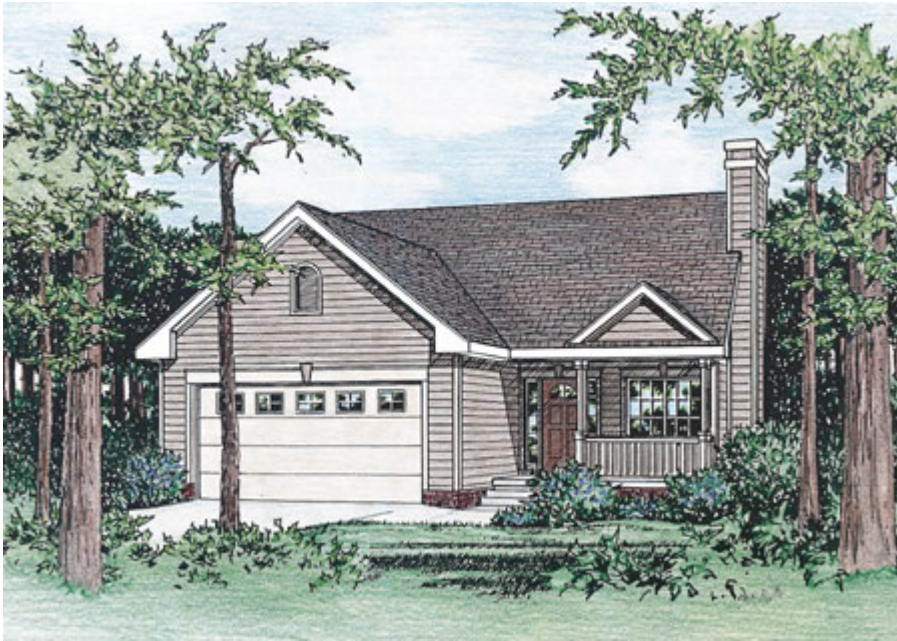

House plans are Copyright © 2009 by our architects and designers.

- NOTE: This house plan is designed for Structural Insulated Panels exterior wall (SIP) construction.
- For the stick-built version, see 41014DB.

Style: Traditional

Total Living Area: 1311

Main Flr.: 1311

Front Porch: 112 sq. ft.

Total Square Feet: 1,862 sq. ft.

Attached Garage: 2 Car, 439 sq. ft.

Bedrooms: 3

Full Bathrooms: 2

Width: 34'8"

Depth: 58'4"

Maximum Ridge Height: 22'

Exterior Walls: SIP

Ceiling Height:

Main Floor: 9'

2nd Floor: 8'

Other: Sloped Great Room, MBR & BR#2; 10' Master Bath; Cathedral Loft

Standard Foundations: Basement

Alternate Foundations: Slab (\$150), Walkout (no charge), Crawl (\$150)

Special Features: Narrow Lot, 1st Floor Master Suite, PDF, CAD Available

One Set	Five Sets	Eight Sets	Reproducible	PDF File	CAD
\$565	\$715	\$775	\$715	\$715	\$1,015

Main Level

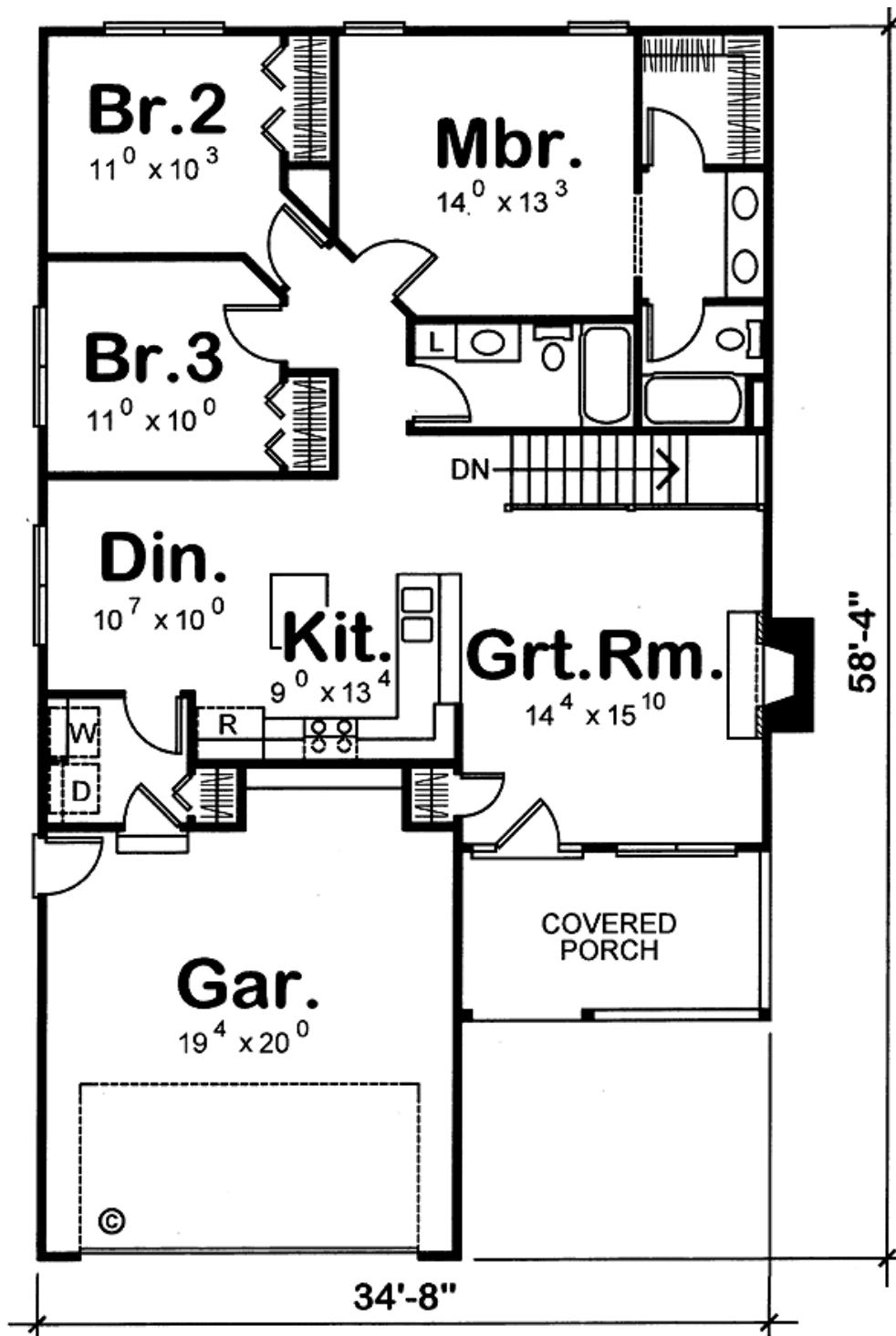

Rear View

